

D 06 FH

Pressure reducing valve with balanced seat High pressure pattern

Product specification sheet

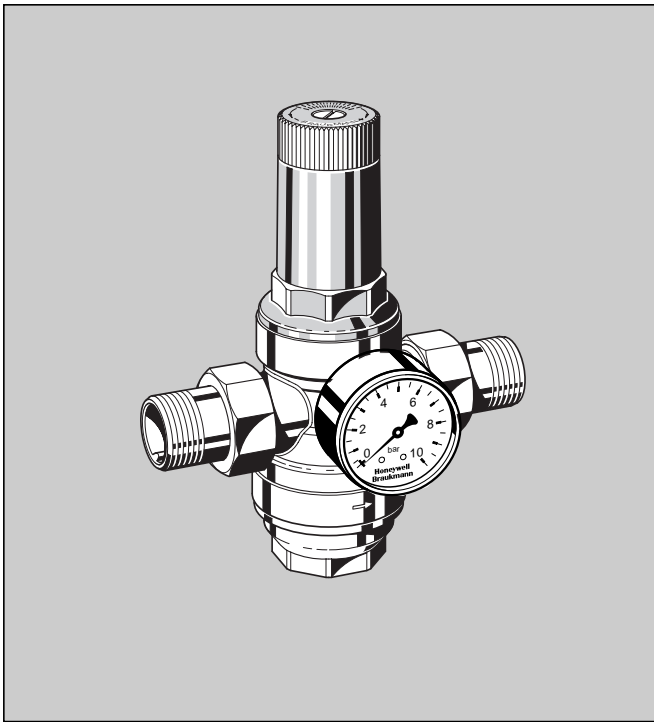

Construction

The pressure reducing valve comprises:

- Housing with G¹/₄" pressure gauge connections on both sides
- Threaded male connections (option B)
- Valve insert complete with diaphragm and valve seat
- Filter with 0.16 mm mesh
- Spring bonnet with adjustment knob
- Filter bowl
- Adjustment spring
- Pressure gauge not included (see accessories)

Materials

- Brass housing
- Brass threaded connections
- High-quality synthetic material valve insert
- Stainless steel filter mesh
- High-quality synthetic material spring bonnet
- Brass filter bowl
- Fibre-reinforced NBR diaphragm
- NBR seals
- Spring steel adjustment spring

Application

D 06 FH pressure reducing valves protect installations against excessive pressure from the supply. They can be used for household, industrial or commercial applications within the range of their specification.

By installing a pressure reducing valve, pressurisation damage is avoided and water consumption is reduced. The set pressure is also maintained constant, even when there is wide inlet pressure fluctuation. Reduction of the operating pressure and maintaining it at a constant level minimises flow noise in the installation.

Special Features

- Adjustment knob for setting the pressure
- The adjustment spring is not in contact with the potable water
- The valve insert is of high quality synthetic material and can be fully interchanged
- Integral filter
- Also available without fittings
- Easily retrofittable to convert valve to a reverse-rinsing filter combination
- Can be retrofitted with an inlet non-return valve
- Inlet pressure balancing – fluctuating inlet pressure does not influence outlet pressure
- **inService** – Servicing and maintenance without removal from pipework
- Light weight
- Reliable and proven

Range of Application

Medium: Water and other non-aggressive liquids, compressed air and nitrogen

Inlet pressure: Maximum 25.0 bar

Outlet pressure: 1.5 – 12.0 bar

Technical Data

Operating temperature: Maximum 70 °C

Connection sizes: 1/2" to 2"

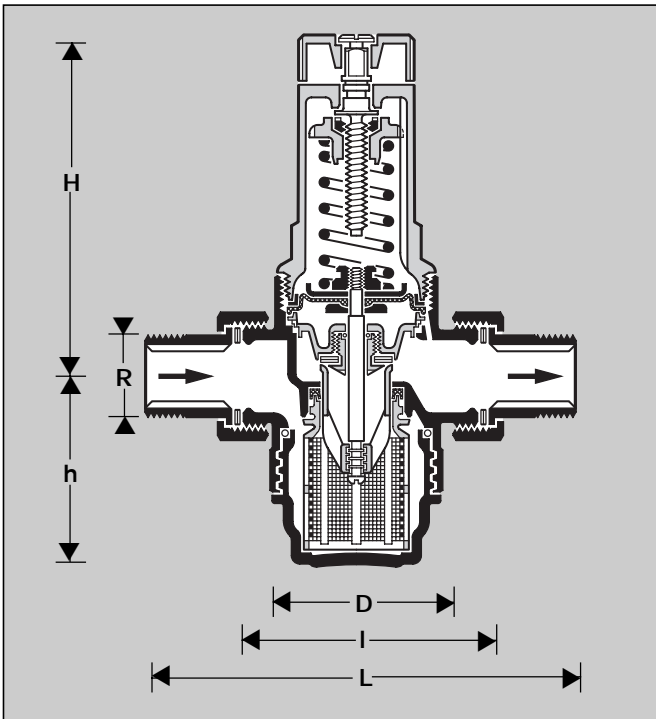

Method of Operation

Spring loaded pressure reducing valves operate by means of a force equalising system. The force of a diaphragm operates against the force of an adjustment spring. If the outlet pressure and therefore diaphragm force fall because water is drawn, the then greater force of the spring causes the valve to open. The outlet pressure then increases until the forces between the diaphragm and the spring are equal again.

The inlet pressure has no influence in either opening or closing of the valve. Because of this, inlet pressure fluctuation does not influence the outlet pressure, thus providing inlet pressure balancing.

Options

D 06 FH - . . . B = With threaded male connection brass filter bowl – up to 70 °C

D 06 FH - . . . F = Without connections, with brass filter bowl – up to 70 °C

┌
└ Connection size

Special versions available on request

Connection size	R	1/2"	3/4"	1"	1 1/4"	1 1/2"	2"
Nominal size	DN	15	20	25	32	40	50
Weight app.	(kg)	0.8	1.0	2.2	2.4	3.4	5.1
Dimensions	mm						
	L	140	160	180	200	225	255
	I	80	90	100	105	130	140
	H	96	96	140	140	172	172
	h	56	56	77	77	113	113
D		54	54	72	72	82	82
k_{vs} -value		2.4	3.1	7.6	9.1	12.6	12.0
Peak flow rate (m ³ /h) according to DIN 1988 PT 5: Household installations Commercial installations		1.8	2.9	4.7	7.2	8.3	13
		1.8	3.3	5.4	8.6	13.7	21.2

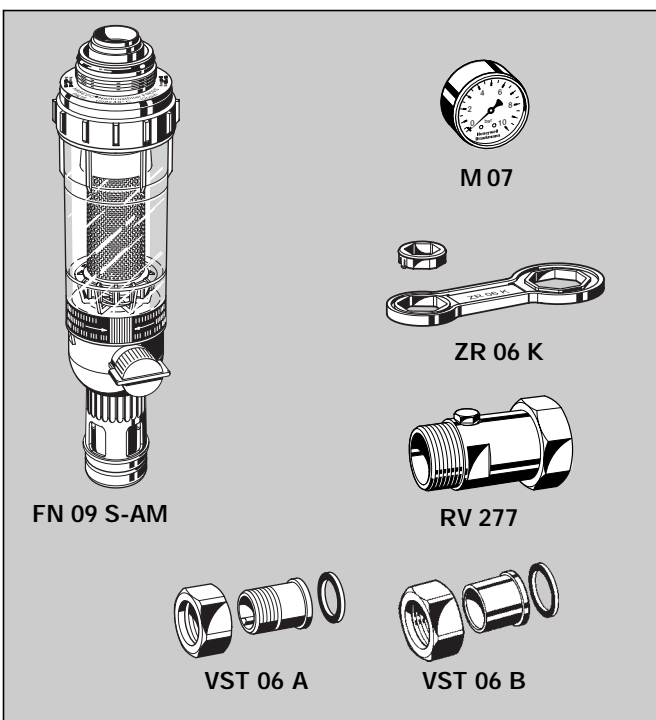

Accessories

FN 09 S-AM HABEDO® retrofit filter

Reverse-rinsing filter with red bronze filter cup (up to 70 °C). For retro-conversion to a filter combination unit of D 06 FH pressure reducing valves made after 1977

M 07

Pressure gauge

Housing diameter 63 mm, rear connection thread G 1/4
Ranges: 0-4, 0-10, 0-16 and 0-25 bar
Please indicate upper value of pressure range when ordering

ZR 06 K

Double ring wrench

For removal of spring bonnet and filter bowl for valves with connection sizes R 1/2" - 2"

RV 277

Inlet non-return valve

For D 06 FH with connection sizes R 3/4" - 2"

VST 06

Connection set

Two threaded or solder connections
A = Threaded connection
B = Solder connections

Installation Example

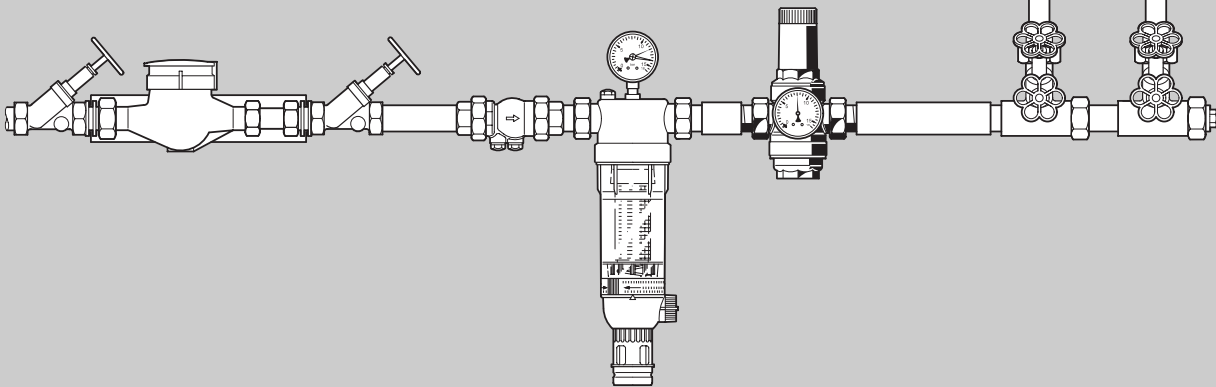

Connection size	R	1/2"	3/4"	1"	1 1/4"	1 1/2"	2"
W*	(mm)	55	55	60	60	70	70

* Minimum distance from wall to centre line of pipework

Installation Guidelines

- If possible install in horizontal pipework with the filter bowl downwards
 - This is the most effective position for cleaning
- Fit shut off valves
 - This permits **inService** – servicing and maintenance without removal from pipework
- Ensure good accessibility
 - So that the pressure gauge can be easily seen
 - Simplifies maintenance and inspection
- Install downstream of the fine filter
 - The pressure reducing valve then has maximum protection against dirt
- If sufficient space is available, it is recommended that a straight section of pipework of at least five times the nominal valve size is provided after the pressure reducing valve

Typical Applications

D 06 FH pressure reducing valves are suitable for household, industrial and commercial applications within the limits of their specifications.

Pressure reducing valves should be installed:

- When the static pressure exceeds the maximum permissible value for the system
- If several pressure zones are required when a pressurisation system is used (pressure reducers on each storey of a building)
- If pressure fluctuations in the downstream system must be avoided
- To achieve constant inlet and outlet pressures on pumped pressure boosting systems

K_{v5}-value Diagram

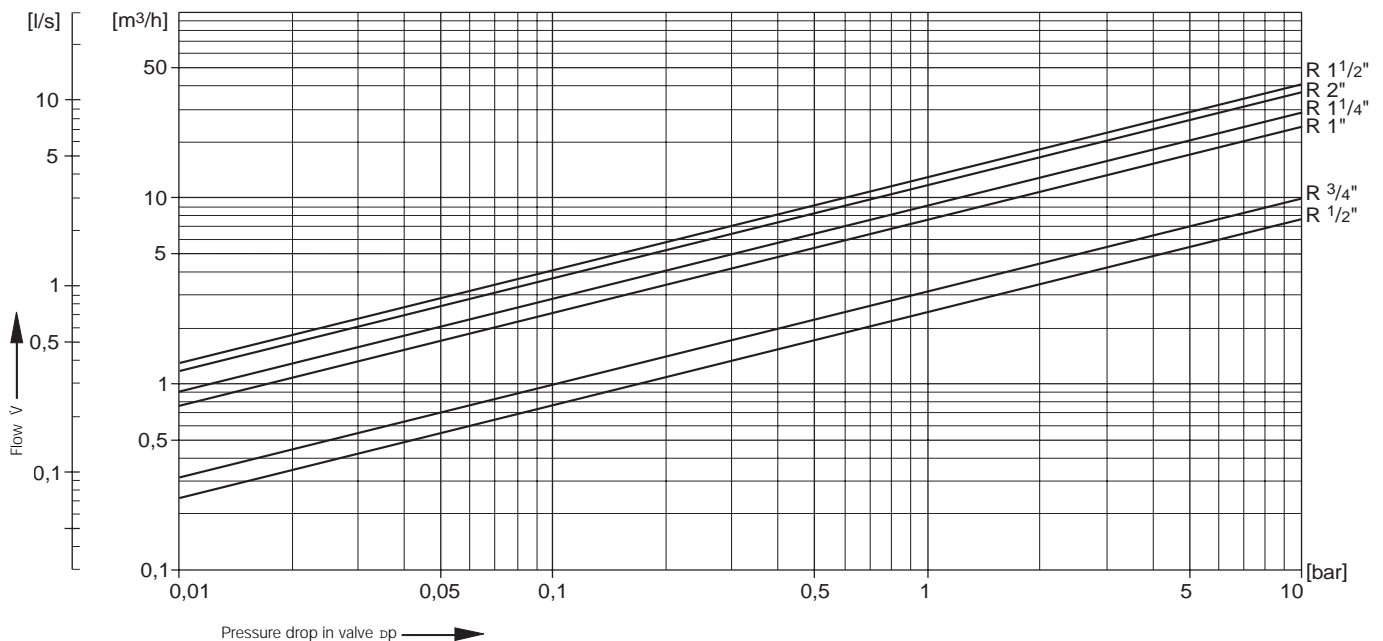

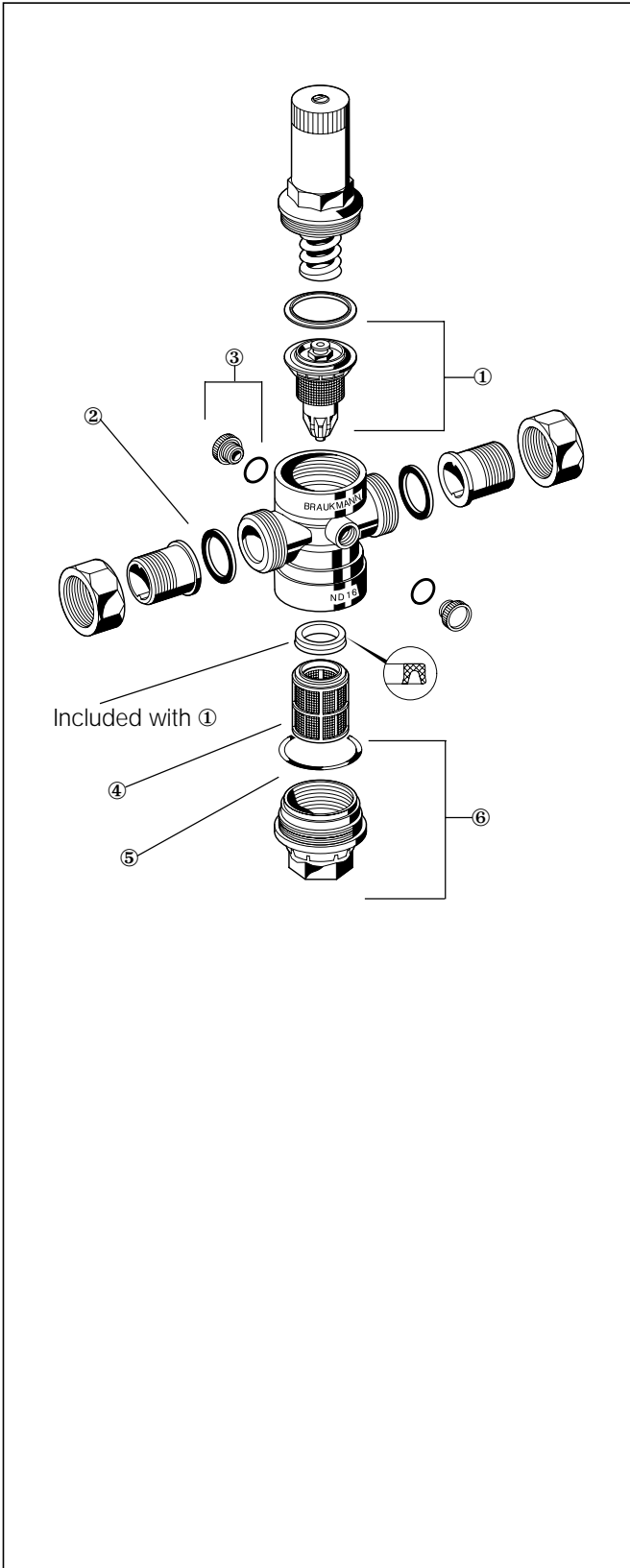

Spare Parts for D06FH Pressure Reducing Valves (From 1977 onwards)

Description	Nominal size	Part number
① Valve insert complete (without filter)	1/2" + 3/4"	D 06 FA - 1/2
	1" + 1 1/4"	D 06 FA - 1A
	1 1/2" + 2"	D 06 FA - 1 1/2
② Gasket ring (10 No.)	1/2"	0901443
	3/4"	0901444
	1"	0901445
	1 1/4"	0901446
	1 1/2"	0901447
	2"	0901448
③ Blanking plug with O-ring R 1/4" (5 No.)	1/2" - 2"	S 06 K - 1/4
④ Replacement filter insert	1/2" + 3/4"	ES 06 F - 1/2 A
	1" + 1 1/4"	ES 06 F - 1A
	1 1/2" + 2"	ES 06 F - 1 1/2 A
⑤ O-ring (10 No.)	1/2" + 3/4"	0901246
	1" + 1 1/4"	0901247
	1 1/2" + 2"	0901248
⑥ Brass filter bowl with O-ring	1/2" + 3/4"	SM 06 T - 1/2
	1" + 1 1/4"	SM 06 T - 1A
	1 1/2" + 2"	SM 06 T - 1 1/2

Subject to change 08/98

Honeywell AG

P.O. Box 1347 · D-74819 Mosbach (Germany)

☎ (+49) 0 62 61/8 10 · Fax (+49) 0 62 61/8 13 09

Honeywell
Braukmann